

Type FLE-PA

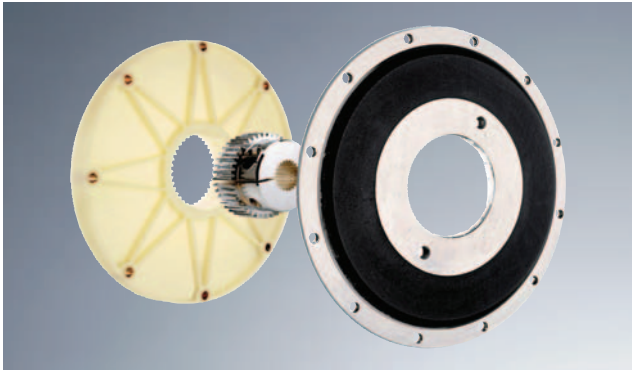

- Flange coupling for connection to I. C.-engines and hydraulic pumps
- Applicable to all hydrostatic drives of construction machines, harvesting machines, etc.
- High torsional stiffness – operation free from resonance
- Maintenance-free due to the material combination nylon/steel
- Nylon flange with high mechanical resistance and thermal strength (+ 130 °C)
- Extremely short assembly
- Easy assembly by axial mounting
- Special mounting flanges available

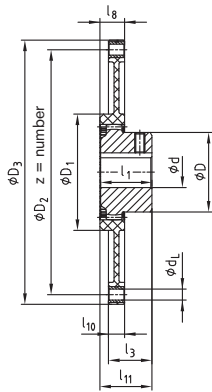

Mounting short

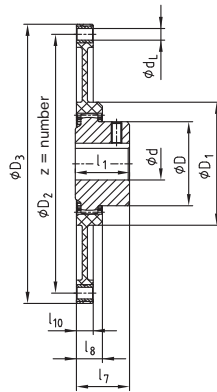

Mounting long

Flange dimensions according to SAE J 620 [mm]				
Size	D ₃	D ₂	z	d _L
6 1/2"	215,9	200,02	6	9
7 1/2"	241,3	222,25	8	9
8"	263,52	244,47	6	11
10"	314,32	295,27	8	11
11 1/2"	352,42	333,37	8	11
14"	466,72	438,15	8	13

Example of installation

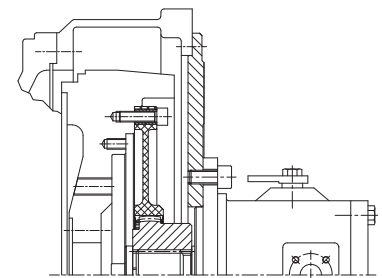

BoWex® FLE-PA for diesel engines with SAE connection; fixing of hub by means of end plate and screw.

BoWex®-FLE-PA – Dimensions/Dimension to SAE																				
Size	Pilot bore	Finish bore d		Dimensions [mm]										Special length l ₁ max.	Dimension to SAE (D ₃)					Max. axial displacement [mm]
		min.	max.	D	D ₁	l ₁	l ₃	l ₇	l ₈	l ₁₀	l ₁₁	6 1/2"	7 1/2"		8"	10"	11 1/2"	14"		
48	-	20	48	68	100	50	41	50	20	13	48	up to 60	●	●	●	●		± 2		
T 48	13	20	48	68	100	50	38	45	20	13	46	-	●	●	●	●		± 1		
T 55	17	20	55	85	115	50	37	48	24	13	48	-	●	●	●	●		± 2		
65 / T 65	21	30	65	96	132	55	45	54	27	21	51	up to 70			●	●	●	± 2		
T 70	26	30	70	100	153	60	48	56	30	21	57	-				●		± 2		
80 / T 80	31	35	80	124	170	90	78	87	30	21	87	-				●		± 2		
100 / T 100	38	40	100	152	265	110	78	108	35	21	110	-				●	●	± 2		
125	45	50	125	192	250	140	37	133	50	28	97	-				●	●	± 2		

Technical data of BoWex® FLE-PA – Torques/Weight/Mass moments of inertia/Torsion spring stiffness															
Size	Torque T _K [Nm]			Weight / Mass moment of inertia J [kgm ²]	Hub with max. bore Ø	FLE-PA flanges according to SAE						Dynamic torsion spring stiffness with + 60 °C / ψ = 0,4 [Nm/rad]			
	T _{KN}	T _{K max.}	T _{KW}			6 1/2"	7 1/2"	8"	10"	11 1/2"	14"	0,30 T _{KN}	0,50 T _{KN}	0,75 T _{KN}	1,00 T _{KN}
48	240	600	120	[kg]	0,79	0,32	0,43	0,51	0,64	-	-	35 x 10 ³	75 x 10 ³	105 x 10 ³	125 x 10 ³
				[kgm ²]	0,0007	0,0021	0,0035	0,0049	0,0085						
T 48	300	750	150	[kg]	0,79	0,32	0,43	0,51	0,64	-	-	40 x 10 ³	86 x 10 ³	120 x 10 ³	143 x 10 ³
				[kgm ²]	0,0007	0,0021	0,0035	0,0049	0,0085						
T 55	450	1125	225	[kg]	1,12	0,34	0,62	0,45	0,646	-	-	90 x 10 ³	140 x 10 ³	170 x 10 ³	195 x 10 ³
				[kgm ²]	0,0016	0,0022	0,0053	0,0044	0,0086						
65	650	1600	325	[kg]	2,30	-	-	0,63	0,64	0,89	-	110 x 10 ³	160 x 10 ³	200 x 10 ³	230 x 10 ³
				[kgm ²]	0,0044			0,0064	0,0065	0,012					
T 65	800	2000	400	[kg]	2,40	-	-	0,63	0,64	0,89	-	130 x 10 ³	190 x 10 ³	240 x 10 ³	280 x 10 ³
				[kgm ²]	0,0044			0,0064	0,0065	0,012					
T 70	1000	2500	500	[kg]	2,60	-	-	-	0,941	-	-	230 x 10 ³	345 x 10 ³	440 x 10 ³	517 x 10 ³
				[kgm ²]	0,0059				0,0132						
80	1200	3000	600	[kg]	5,20	-	-	-	1,05	1,12	-	200 x 10 ³	410 x 10 ³	580 x 10 ³	700 x 10 ³
				[kgm ²]	0,0151				0,015	0,022					
T 80	1500	3750	750	[kg]	5,20	-	-	-	1,05	1,12	-	240 x 10 ³	450 x 10 ³	638 x 10 ³	770 x 10 ³
				[kgm ²]	0,0151				0,015	0,022					
100	2050	5150	1025	[kg]	9,37	-	-	-	-	1,16	8,45	500 x 10 ³	700 x 10 ³	856 x 10 ³	950 x 10 ³
				[kgm ²]	0,0401					0,021	0,234				
T 100	2500	6250	1250	[kg]	9,37	-	-	-	-	1,16	8,45	600 x 10 ³	830 x 10 ³	960 x 10 ³	1070 x 10 ³
				[kgm ²]	0,0401					0,021	0,234				
125	4250	10700	2125	[kg]	19,73	-	-	-	-	2,09	9,85	4200 x 10 ³	5000 x 10 ³	5600 x 10 ³	6200 x 10 ³
				[kgm ²]	0,1359					0,043	0,306				